

Sistema di distribuzione

Distribution system

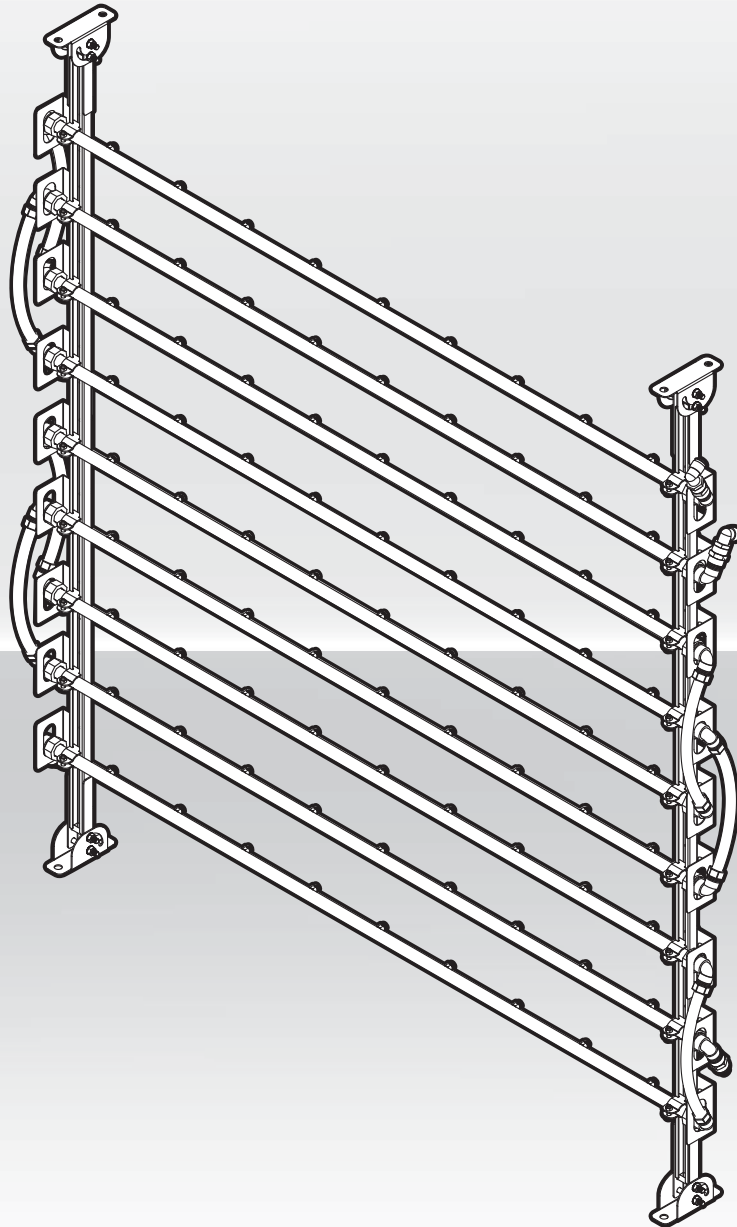

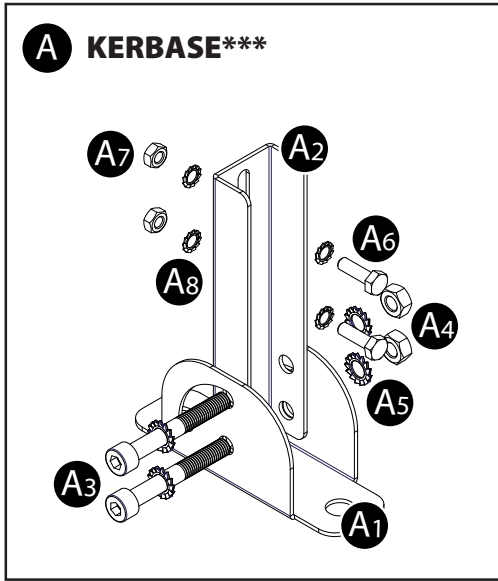

E KERJNT****

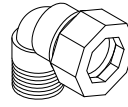

B KERRAIL***



G ECKN*****

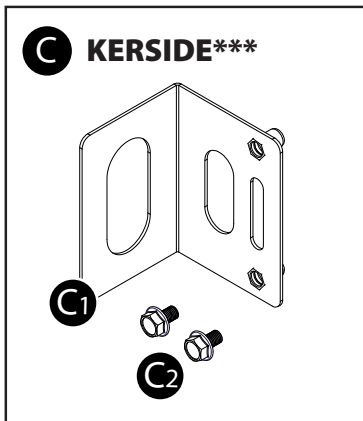

H KERFLX****

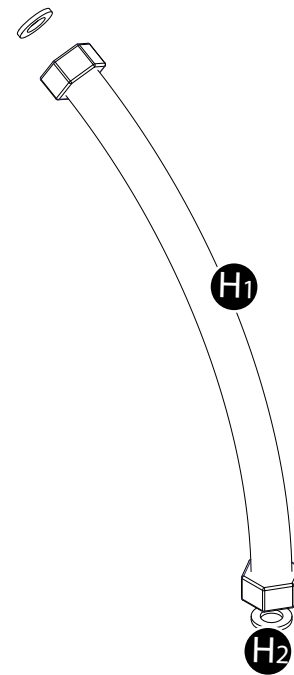

D KERPIP****

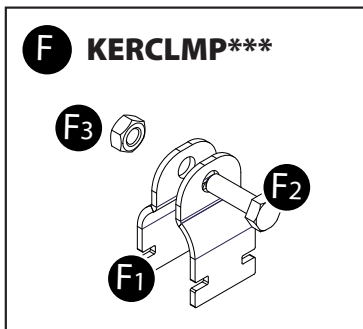
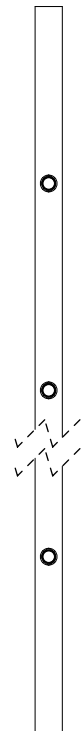

I KERDFL****

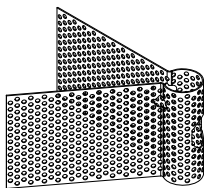

L KERIN*****

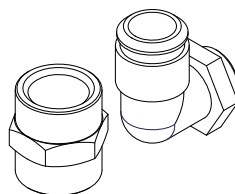

M KEROUT****

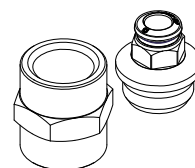

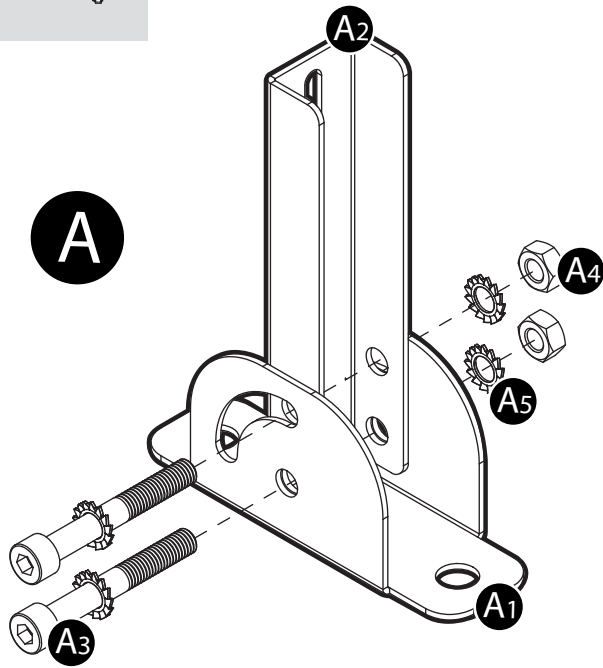
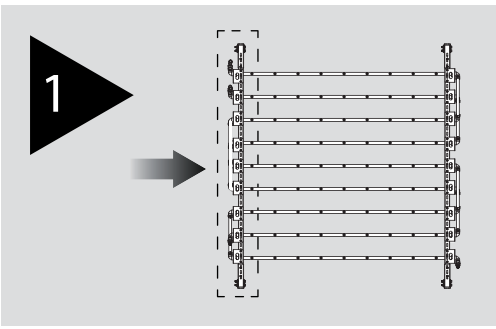

1 OR 2

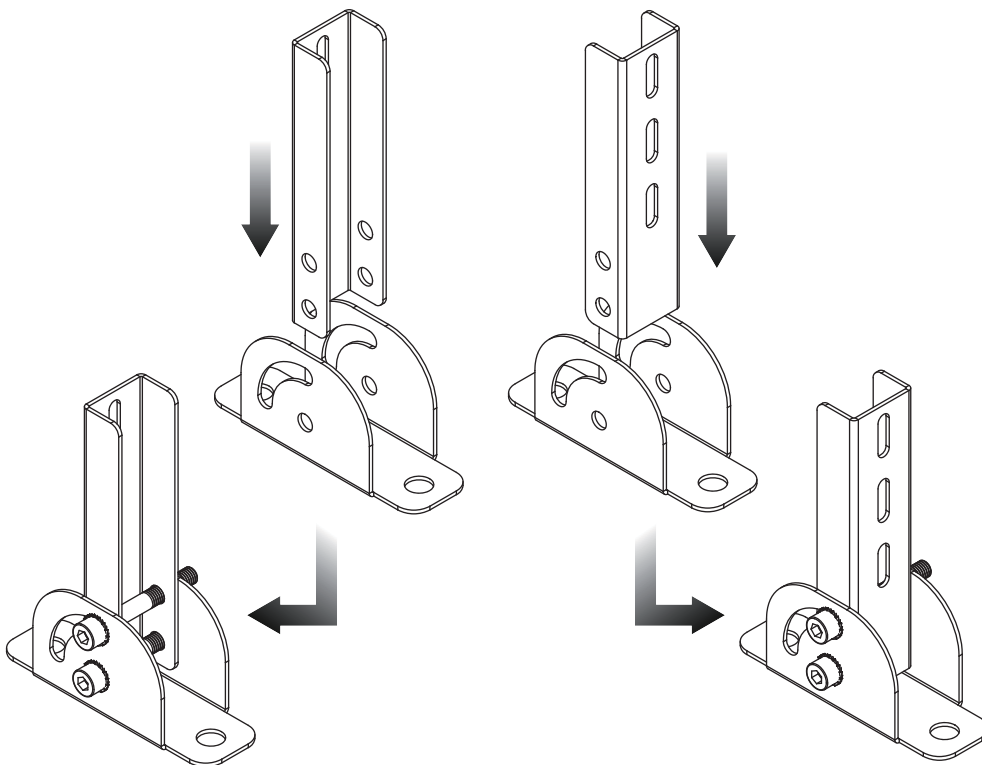

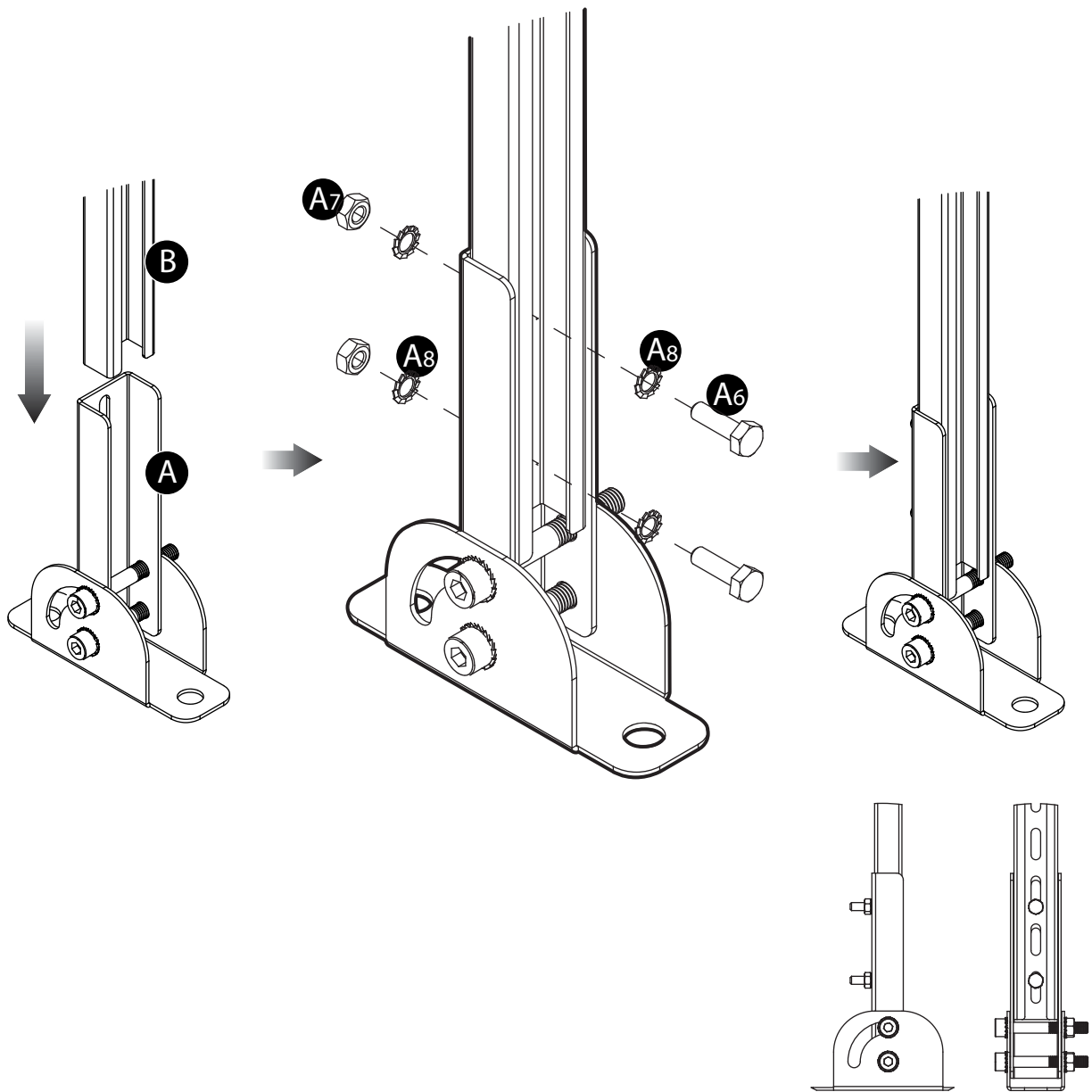
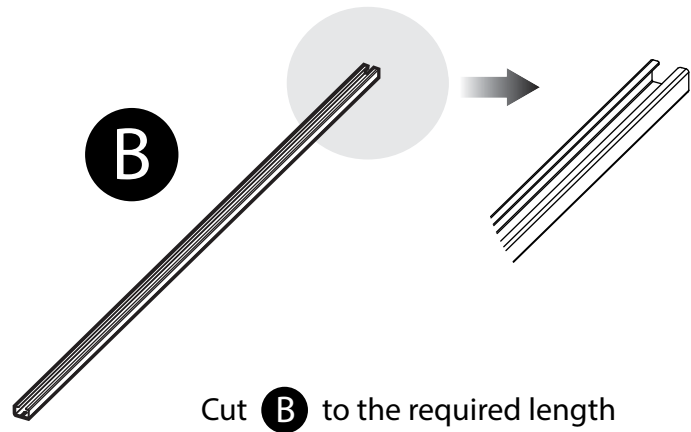
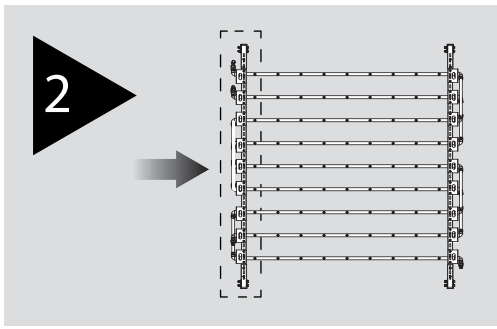

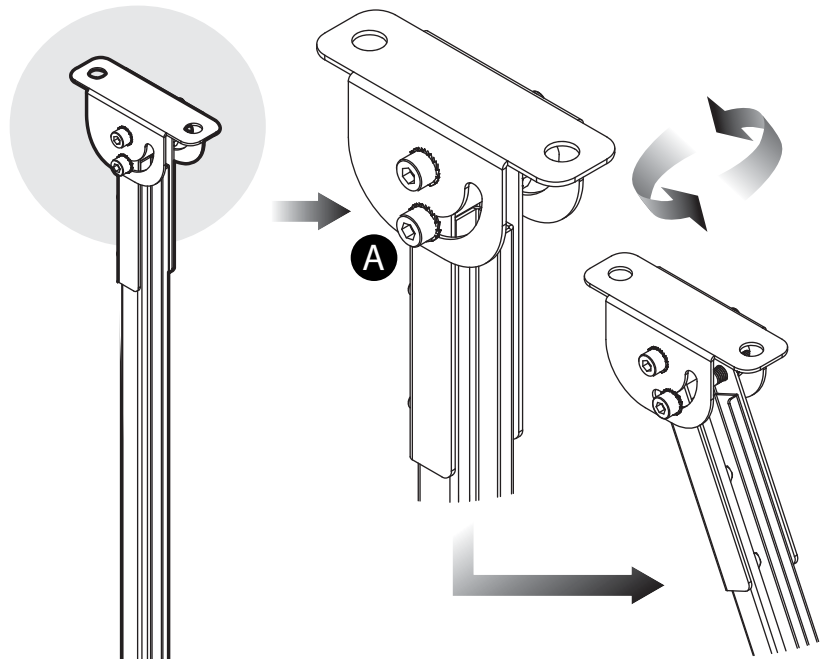
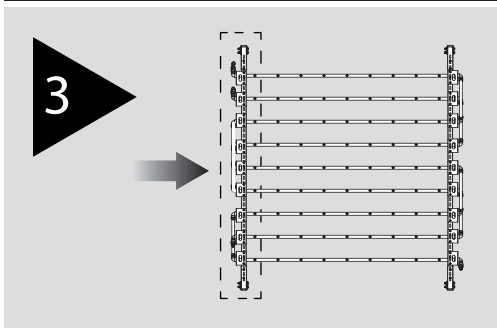

Attention! Change the orientation of **A** to tilt the rail after assembly if necessary.

Attention! Change the orientation of **A** to tilt the rail after assembly if necessary.

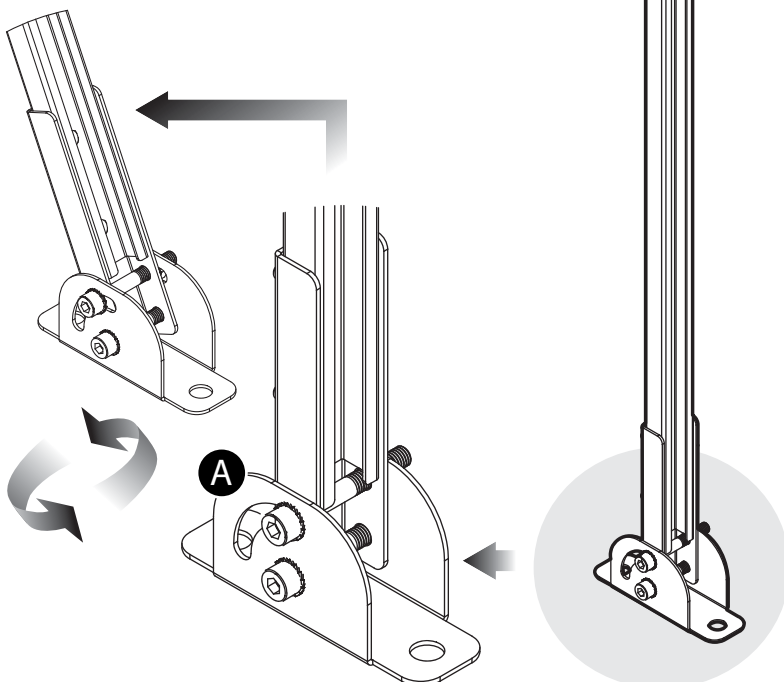

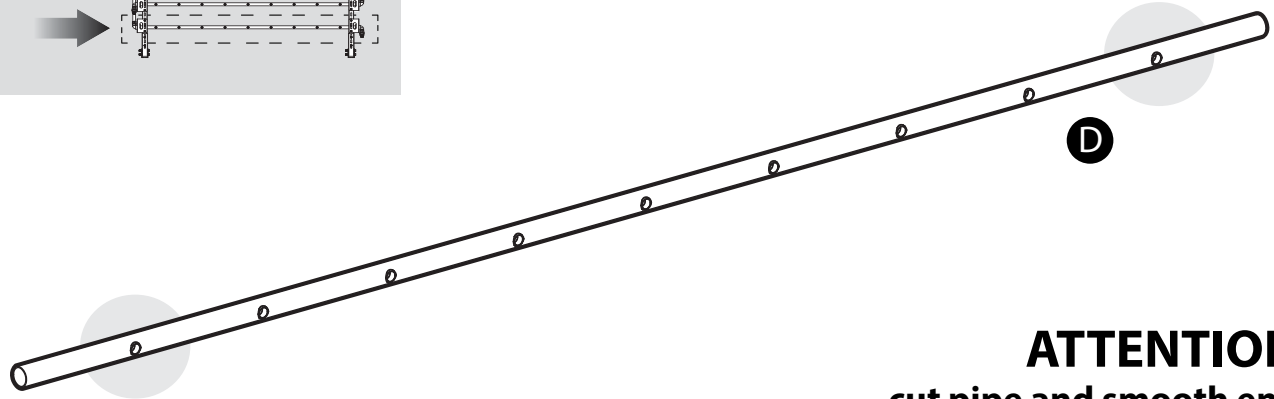
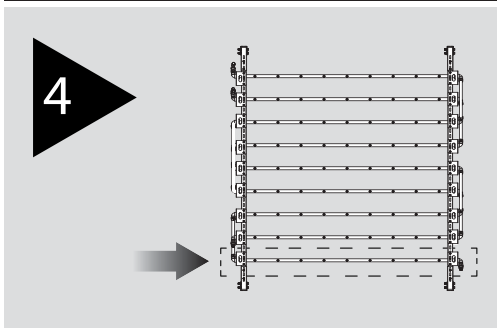

ATTENTION
cut pipe and smooth end

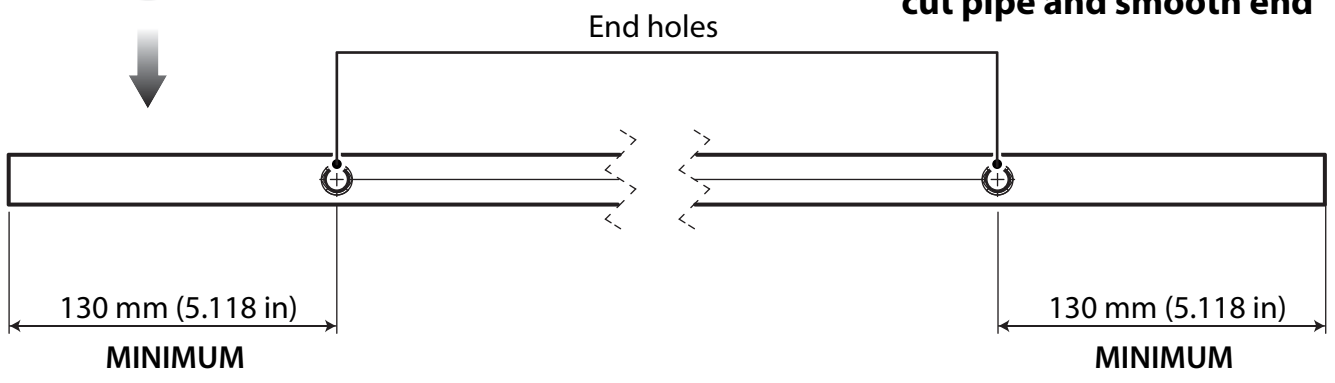

All pipes in the same rack must be cut to the same length

Example of minimum pipe length

Pipe with holes spaced 152 mm (5.98 in) apart

Holes number	1	2	3	4	5	6	7	8	9	10	11	12	13	14	15	16	17	18	19
Pipe length (mm)	260	412	564	716	868	1020	1172	1324	1476	1628	1780	1932	2084	2236	2388	2540	2692	2844	2996
Pipe length (in)	10,2	16,2	22,2	28,2	34,2	40,1	46,2	52,1	58,1	64,1	70,1	76,0	82,0	88,0	94,0	100,0	106,0	111,9	118,0

Pipe with holes spaced 228 mm (8.98 in) apart

Holes number	1	2	3	4	5	6	7	8	9	10	11	12	13
Pipe length (mm)	260	488	716	944	1172	1400	1628	1856	2084	2312	2540	2768	2996
Pipe length (in)	10,2	19,2	28,2	37,2	46,2	55,1	64,1	73,1	82,0	91,1	100,0	109,0	118,0

Pipe with holes spaced 304 mm (11.98 in) apart

Holes number	1	2	3	4	5	6	7	8	9	10
Pipe length (mm)	260	564	868	1172	1476	1780	2084	2388	2692	2996
Pipe length (in)	10,2	22,2	34,2	46,2	58,1	70,1	82,0	94,0	106,0	118,0

5

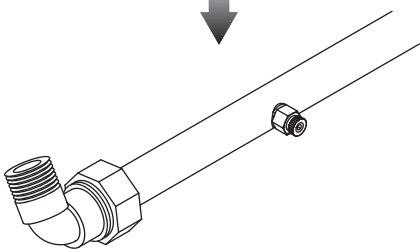
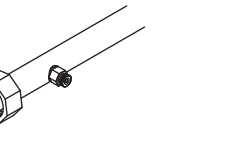
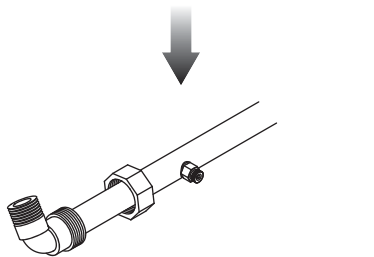
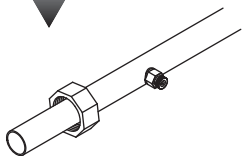
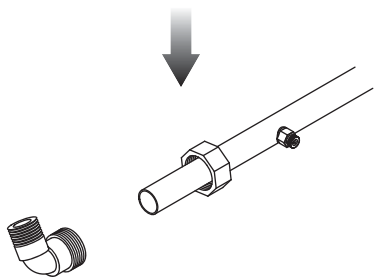
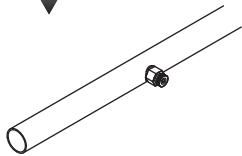
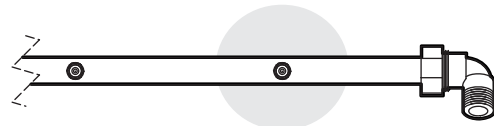
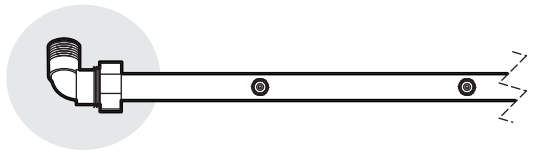
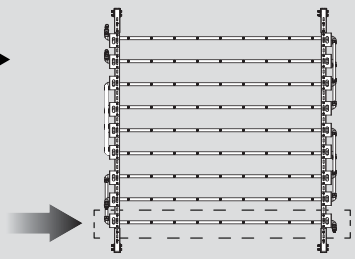

Push the fitting onto the pipe until it sits into place

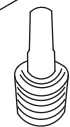
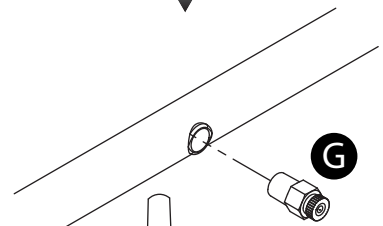
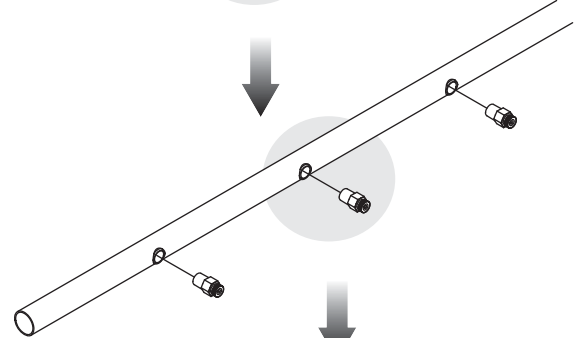

Sealant on nozzle thread



wait 6 h before use with water

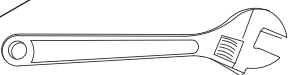
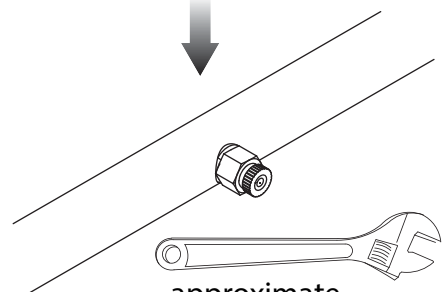

approximate tightening torque

$5 < \mathbf{G} < 6 \text{ N m}$

$44 < \mathbf{G} < 53 \text{ lb in}$

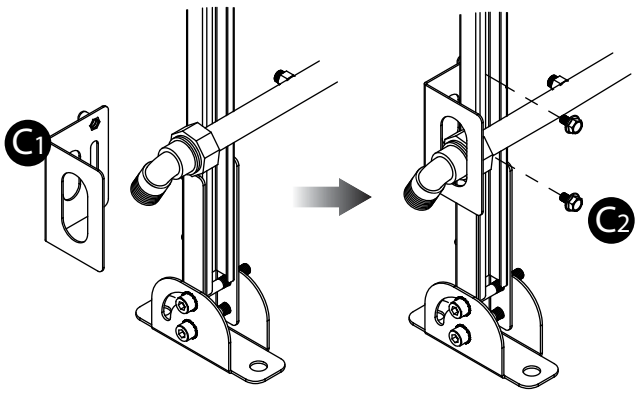
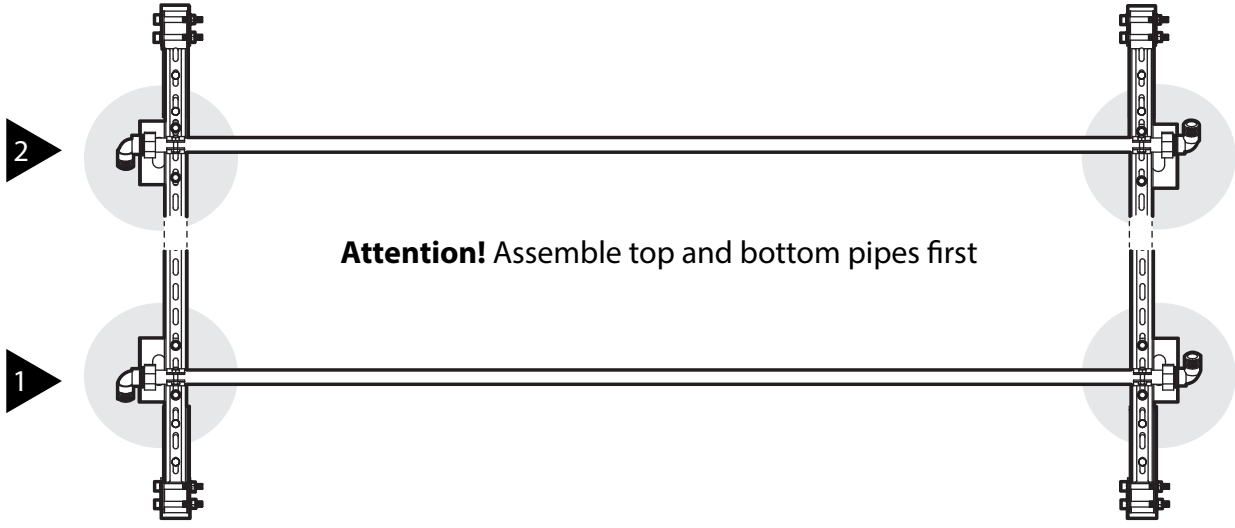
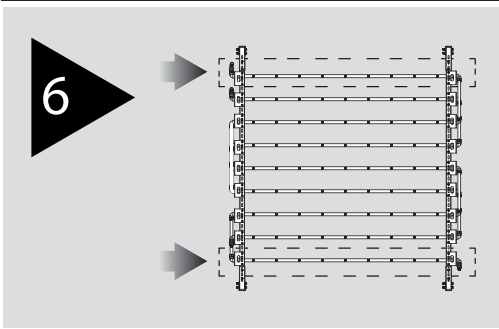

approximate dimension 78 mm (3.1 in)

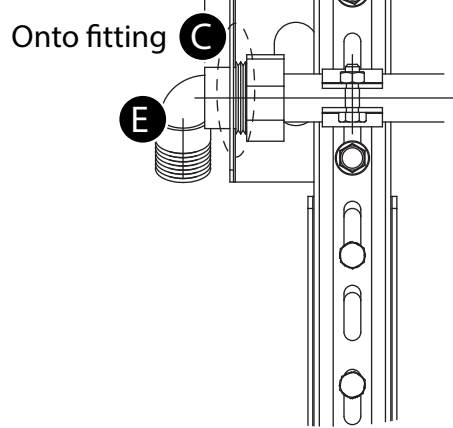

Attention! Attach side element

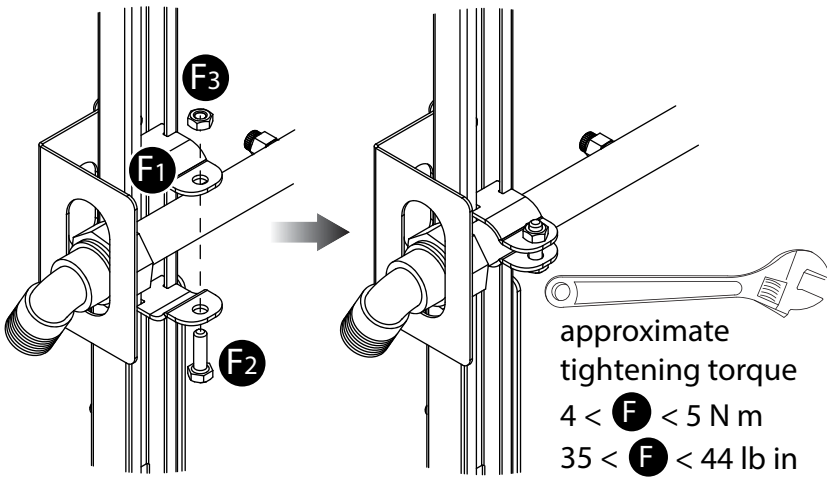

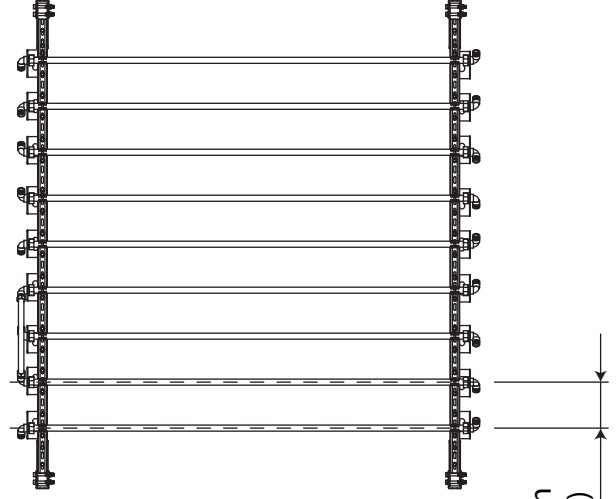
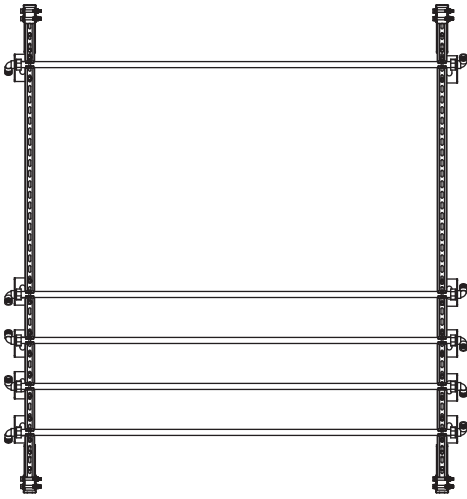
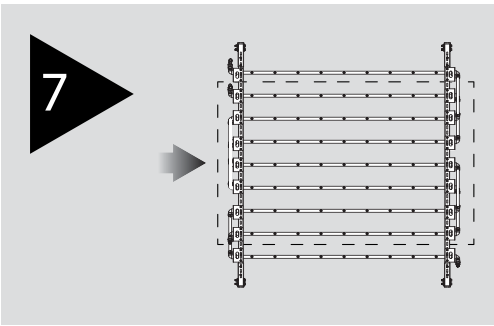

At least
152 mm
(5.98 in)

Choose the direction of nozzles

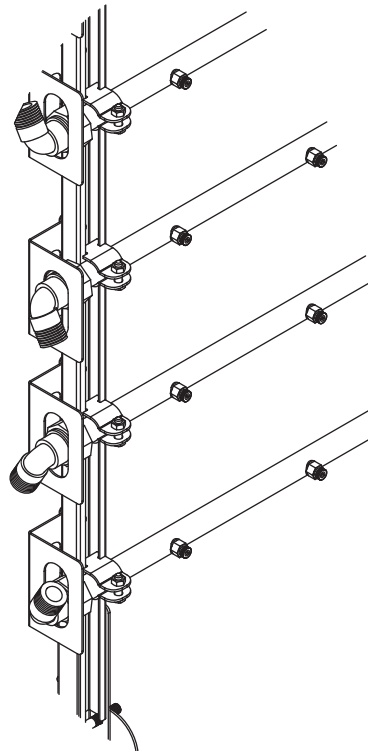
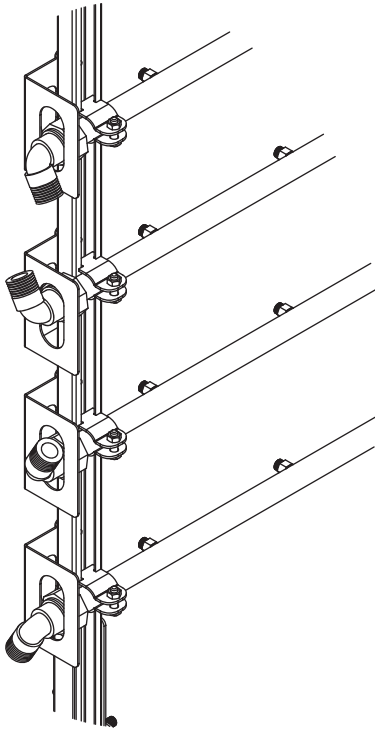

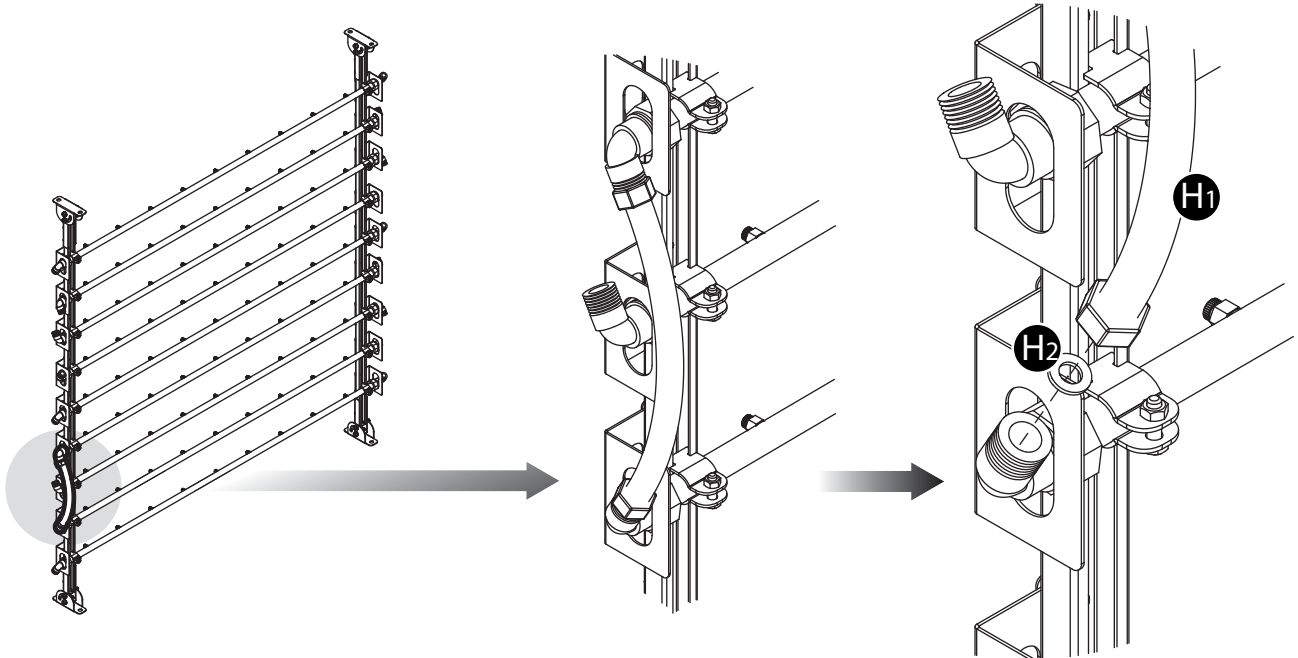
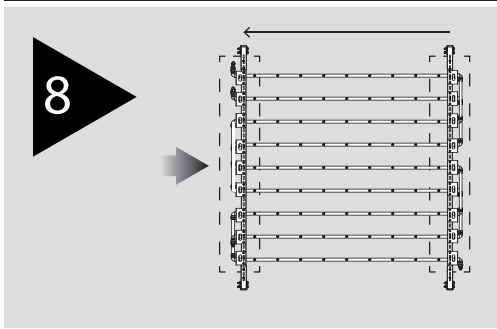

Configurations examples

Choose between one step and two step options

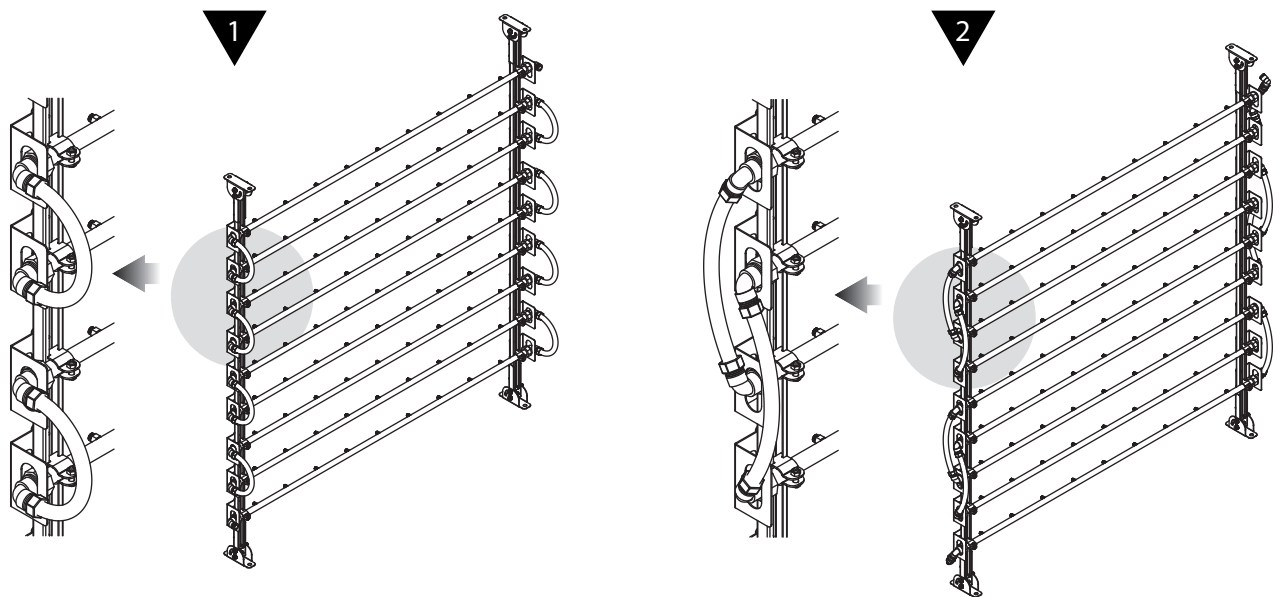

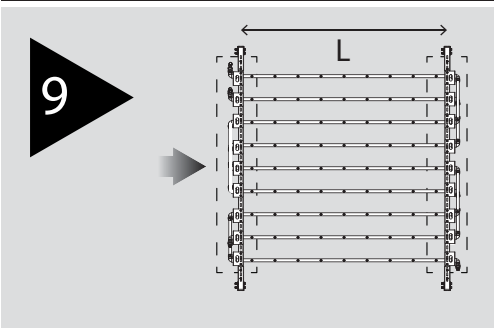

Water inlet on top

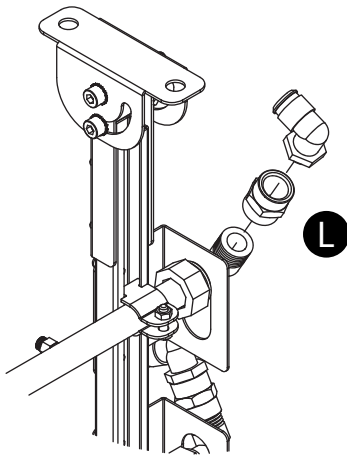

Water outlet on bottom

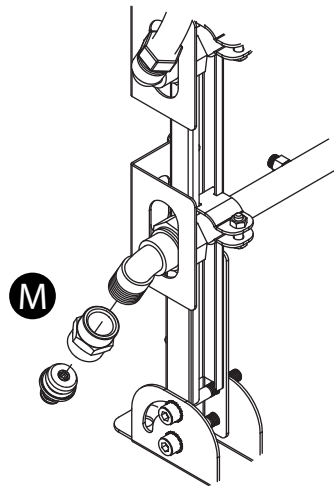

Attention!!

If $L > 1,5 \text{ m}$ ($L > 59 \text{ in}$) an additional middle rail with clamps is recommended

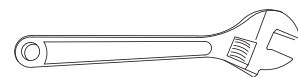
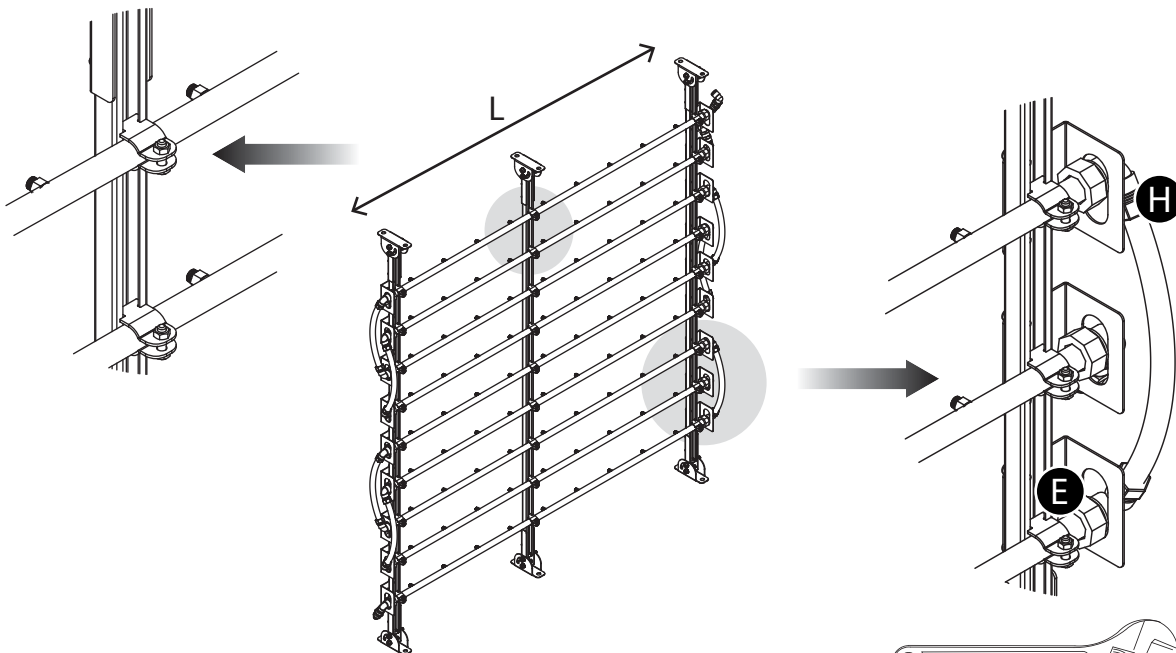

approximate
tightening torque

$7 < \text{H} < 8 \text{ N m}$ $8 < \text{E} < 9 \text{ N m}$
 $62 < \text{H} < 71 \text{ lb in}$ $71 < \text{E} < 79 \text{ lb in}$

10

